

Active Healthcare Solutions Ltd.

163- 5489 Byrne Road
Burnaby, BC Canada
+1 (778) 706-8910
info@activehs.ca



JAECOMultiLink Mobile Arm Support Order form

Dealer _____ Customer _____
Wheelchair Model _____ Joystick Model _____
Address _____ Province _____ Postal code _____
Telephone _____
E-mail _____ **PO #** _____
Dealer's signature: _____ Date ___ / ___ /20___ Customer's signature: _____
Per confirmation

1. Select MultiLink Arm MRSP

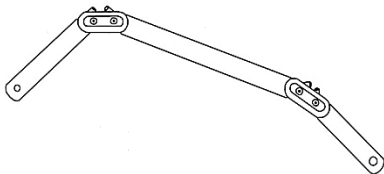

JMA-1 \$550
20in. MultiLink Arm (Standard)

JMA-2 \$550
24in. MultiLink Arm

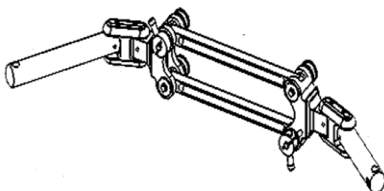

JME-1 \$1575
21 in. Elevating MultiLink Arm

JME-2 \$1575
22 in. Elevating MultiLink Arm

2. Select MultiLink Mount

MRSP



Rancho **JRMT-1**

\$1065

Mobile Arm Support Mounts with angle adjustments



Table Mount **TM-1**

\$300

The Table Mount to increases client functional range.

3. Select Mount Relocator: (if needed)

MRSP

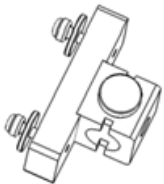

MR-7

For Molded Backrest

\$470

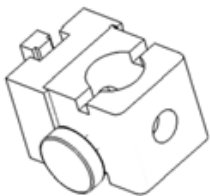

MR-8

For Keyed Back Post

\$470

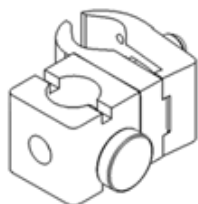

MR-10

For Tubular Back Post

\$470

Active Healthcare Solutions Ltd.

163- 5489 Byrne Road
 Burnaby, BC Canada
 +1 (778) 706-8910
info@activehs.ca



4. Select MultiLink Forearm Support **MRSP**

FSAS-6 \$475
6 in. Pediatric

FSAS-8 \$475
8 in. Small

FSAS-9 \$475
9 in. Medium

FSAS-10 \$475
10 in. Large

FSAS-11 \$475
11 in. Extra Large

FSAS-11 \$550
****Custom: Supply measurements**

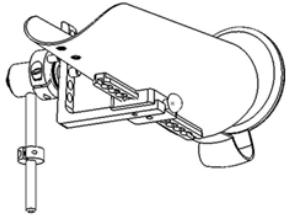

****Forearm Measurements:**

A: _____

B: _____

C: _____

D: _____

5. Select Accessory: **MRSP**

FSC-1 \$85
Forearm Support Cover

JRHA-1 \$650
MultiLink Height Adjuster